

茨木市北春日丘三丁目57番7 分筆予定図1 S=1/200

求積表

① A1					
地番	NO	Xn	Yn	Yn+1-Yn-1	Xn · (Yn+1-Yn-1)
	K1	-130890.088	-42056.722	25.240	-3303665.821120
	A17	-130906.195	-42035.596	16.083	-2105364.334185
	A16	-130912.812	-42040.639	-14.431	1889202.789972
	A14	-130905.654	-42050.027	-8.539	1117803.379506
	A15	-130904.540	-42049.178	-10.809	1414947.172860
	A1	-130895.654	-42060.836	-7.544	987476.813776
	合計				400.000809
	合計面積				200.0004045
	地積				200.00 m ²

② A2					
地番	NO	Xn	Yn	Yn+1-Yn-1	Xn · (Yn+1-Yn-1)
	A1	-130895.654	-42060.836	13.679	-1790521.651066
	A15	-130904.540	-42049.178	10.809	-1414947.172860
	A14	-130905.654	-42050.027	8.539	-1117803.379506
	A16	-130912.812	-42040.639	14.431	-1889202.789972
	A17	-130906.195	-42035.596	7.218	-944880.915510
	M104	-130907.853	-42033.421	2.501	-327400.540353
	M107	-130908.102	-42033.095	10.459	-1369167.838818
	M105	-130915.862	-42022.962	12.017	-1573215.913654
	K5	-130917.221	-42021.078	-6.105	799249.634205
	A7	-130924.151	-42029.067	-20.656	2704369.263056
	A12	-130914.493	-42041.734	-33.790	4423600.718470
	A6	-130898.389	-42062.857	-19.102	2500421.026678
	合計				500.440670
	合計面積				250.2203350
	地積				250.22 m ²

③ A3					
地番	NO	Xn	Yn	Yn+1-Yn-1	Xn · (Yn+1-Yn-1)
	A6	-130898.389	-42062.857	-25.236	3303351.744804
	A8	-130903.956	-42066.970	7.543	-987408.540108
	A9	-130912.843	-42055.314	10.806	-1414644.181458
	A13	-130913.957	-42056.164	8.535	-1117350.622995
	A11	-130921.111	-42046.779	14.430	-1889191.631730
	A12	-130914.493	-42041.734	-16.078	2104843.218454
	合計				-400.013033
	合計面積				200.0065165
	地積				200.00 m ²

④ A4					
地番	NO	Xn	Yn	Yn+1-Yn-1	Xn · (Yn+1-Yn-1)
	A8	-130903.956	-42066.970	13.688	-1791813.349728
	A9	-130912.843	-42055.314	10.806	-1414644.181458
	A13	-130913.957	-42056.164	8.535	-1117350.622995
	A11	-130921.111	-42046.779	14.430	-1889191.631730
	A12	-130914.493	-42041.734	17.712	-2318757.500016
	A7	-130924.151	-42029.067	7.357	-963208.978907
	K4	-130928.757	-42034.377	-8.318	1089065.400726
	DD213	-130931.464	-42037.385	-3.151	412565.043064
	K3	-130931.167	-42037.528	-12.943	1694642.094481
	DD35	-130922.140	-42050.328	-18.055	2363799.237700
	DD36	-130917.867	-42055.583	-7.830	1025086.898610
	DD159	-130915.726	-42058.158	-13.419	1756758.127194
	K2	-130906.705	-42069.002	-8.812	1153549.884460
	合計				500.421401
	合計面積				250.2107005
	地積				250.21 m ²

総合計面積	900.4379565 m ²
-------	----------------------------

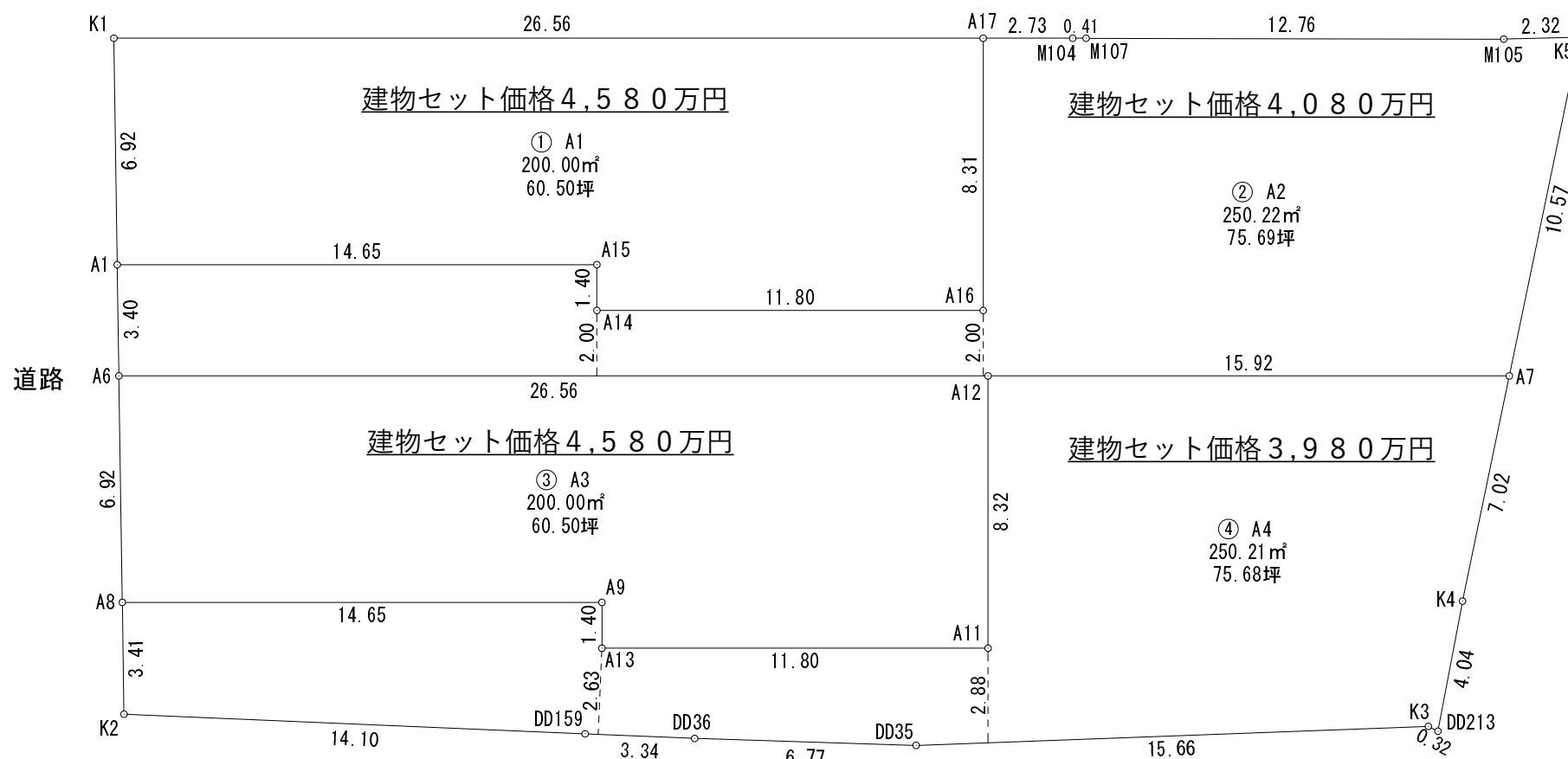

図面名	分筆予定図1		
所在地	茨木市北春日丘三丁目57番7		
縮尺	1/200	作成年月日	令和元年10月23日
備考			
作成者	尼崎市富松町4丁目1番6号 土地家屋調査士 高橋計二 TEL 06-6420-7772 登録番号第2127号		